

WINCORE™

WINDOWS & DOORS

250 Staunton Turnpike, Parkersburg, WV 26104

8800 Series Vinyl Outswing Casement Window "IMPACT"

GENERAL NOTES

1. This product has been evaluated and is in compliance with the 8th Edition (2023) Florida Building Code (FBC) structural requirements excluding the "High Velocity Hurricane Zone" (HVHZ).
2. Product anchors shall be as listed and spaced as shown on details. Anchor embedment to base material shall be beyond wall dressing or stucco.
3. When used in areas requiring wind borne debris protection this product complies with FBC Sections 1609.1.2 & R301.2.1.2 and does not require an impact resistant covering. This product meets missile level "D" and includes Wind Zone 4 as defined in ASTM E1996 and FBC Sections 1609.1.2.2 & R301.2.1.2.1.
4. For 2x stud framing construction, anchoring of these units shall be the same as that shown for 2x buck masonry construction.
5. Site conditions that deviate from the details of this drawing require further engineering analysis by a licensed engineer or registered architect.

TABLE OF CONTENTS	
SHEET#	DESCRIPTION
1	Typical elevations, design pressures and general notes
2	Horizontal & vertical cross sections
3	Horizontal & vertical cross sections
4	Buck and frame anchoring
5	Bill of materials, components and glazing details

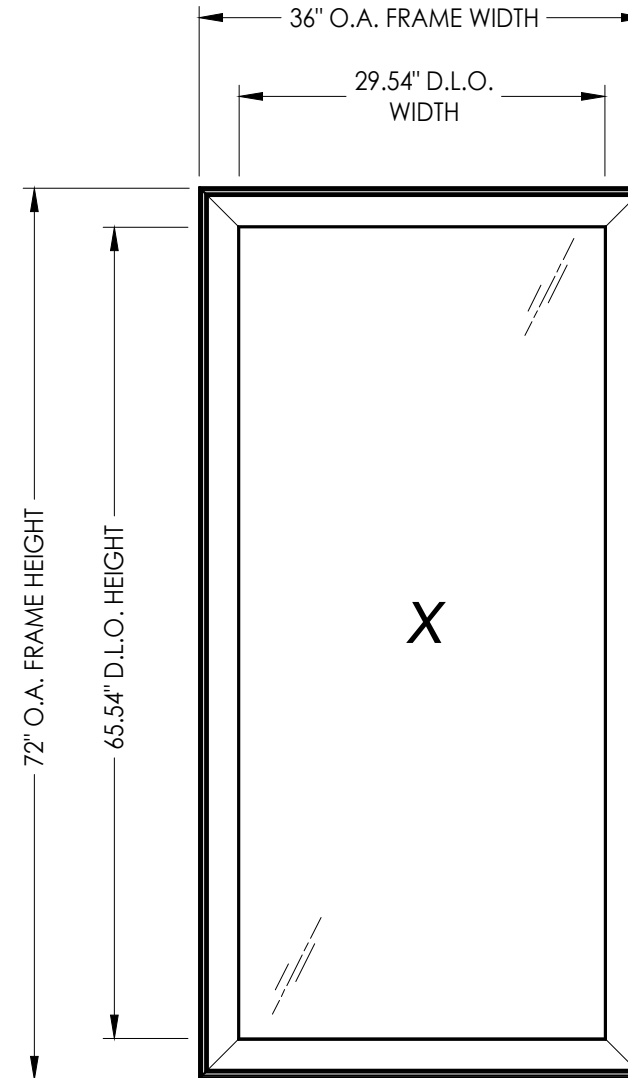

MAX. FRAME DIMENSION	MAX. D.L.O. DIMENSION	GLASS TYPE	DESIGN PRESSURE (PSF)	
			POSITIVE	NEGATIVE
36.0" X 72.0"	29.54" X 65.54"	G1	+50.0	-50.0
		G2	+55.0	-55.0
		G3	+65.0	-70.0

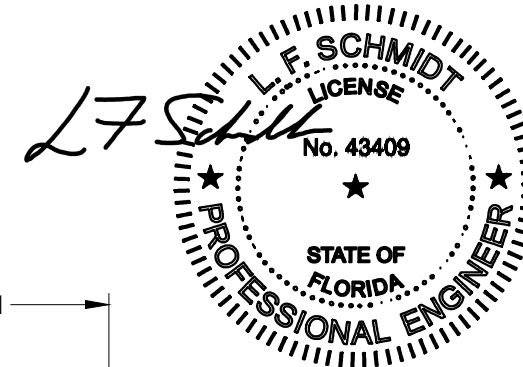

This item has been digitally signed and sealed by L. F. Schmidt, P.E. on the date adjacent to the seal. Printed copies of this document are not considered signed and sealed and the signature must be verified on any electronic copies.

THIS PRODUCT APPROVAL IS VALID ONLY FOR THE STATE OF FLORIDA

Documents Prepared By:
Lyndon F. Schmidt
P.E. No. 43409

RW BUILDING CONSULTANTS, INC.
P.O. Box 230, Vairico, FL 33595
Phone No.: 813.659.9197
FBPE Registry No. 9813

PRODUCT: 8800 SERIES Vinyl Outswing Casement Window
PART OR ASSEMBLY: TYPICAL ELEVATION, DESIGN PRESSURES & GENERAL NOTES

NO.	DATE	REVISIONS
6	7/06/23	UPDATE TO 8TH ED. (2023) FBC
5	7/02/20	UPDATE TO 7TH ED. (2020) FBC
4	4/11/19	REVISE FOR NEW HARDWARE
3	6/01/17	UPDATE TO 6TH ED. (2017) FBC
2	1/28/15	UPDATE TO 5TH ED. (2014) FBC
1	4/04/13	UPDATED D.P./GLAZING

DATE: 8/2/12

SCALE: N.T.S.

DWG. BY: JK

CHK. BY: LFS

DRAWING NO.:

FL-15817.2

SHEET 1 OF 5

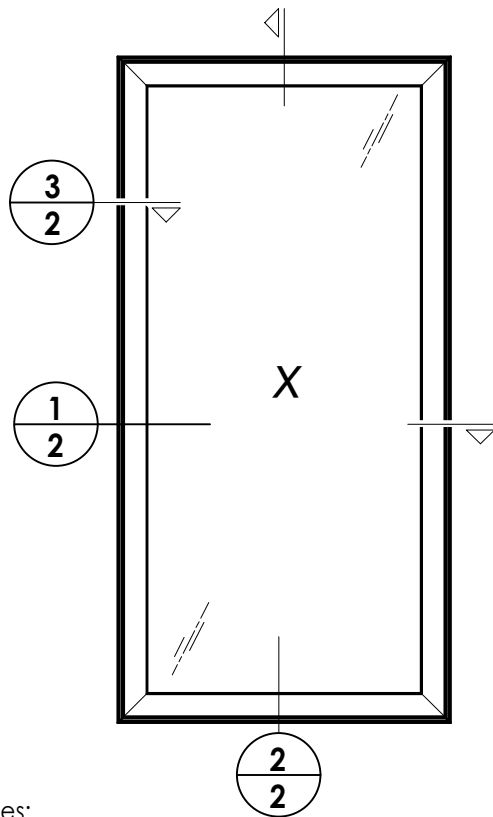

- Notes:
1. Multi-point locks/keepers (4) located at 4.125", 25.75", 46.5" & 66.375" from the bottom of sash.
 2. Items L & J located in one hole of tie bar guide (1 total per guide).
 3. Item G located in outside holes of operator base (2 total).
 4. Item K located in one hole of snubber (1 total per snubber).

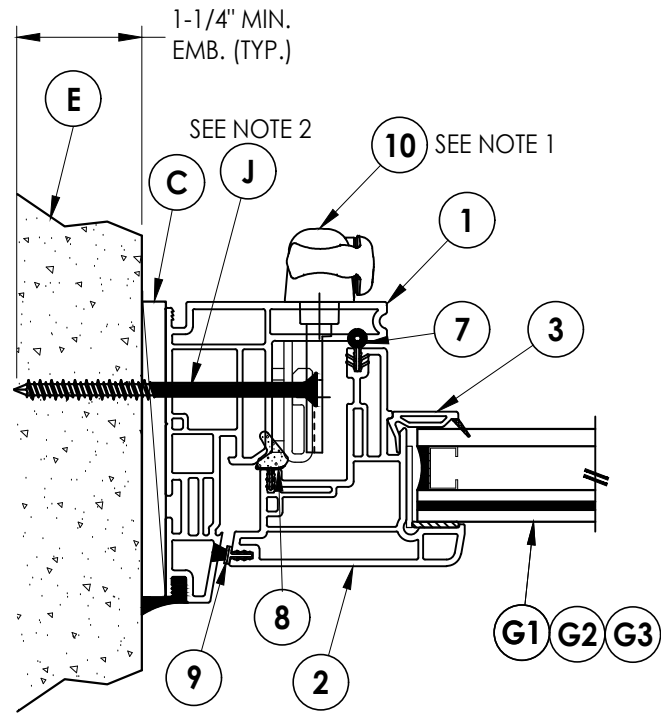

3 HORIZONTAL CROSS SECTION
2 Shown Direct to Masonry

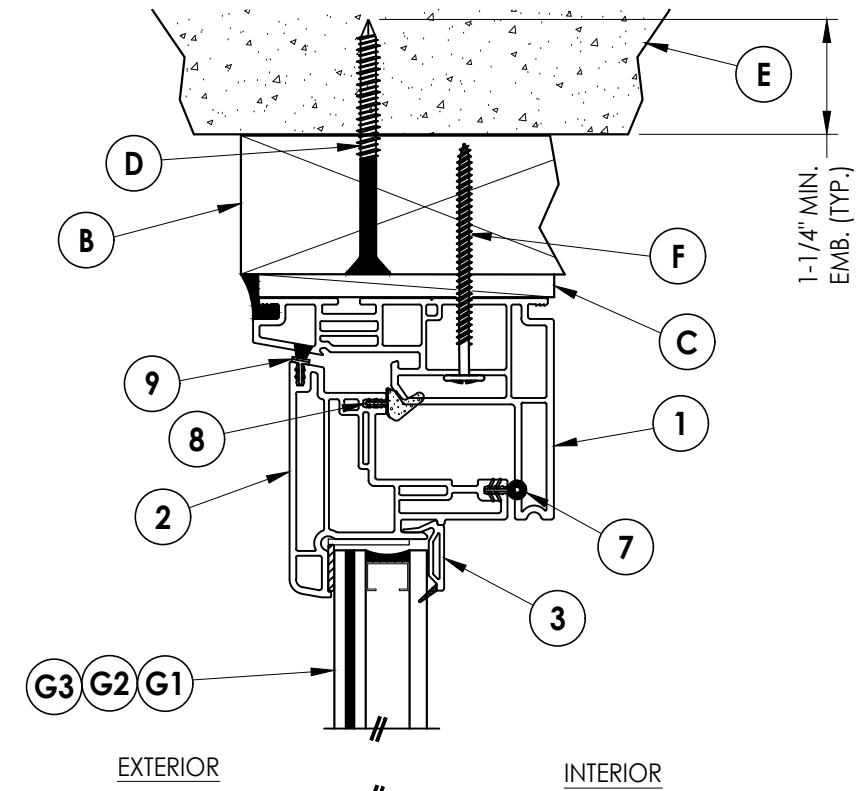

EXTERIOR INTERIOR

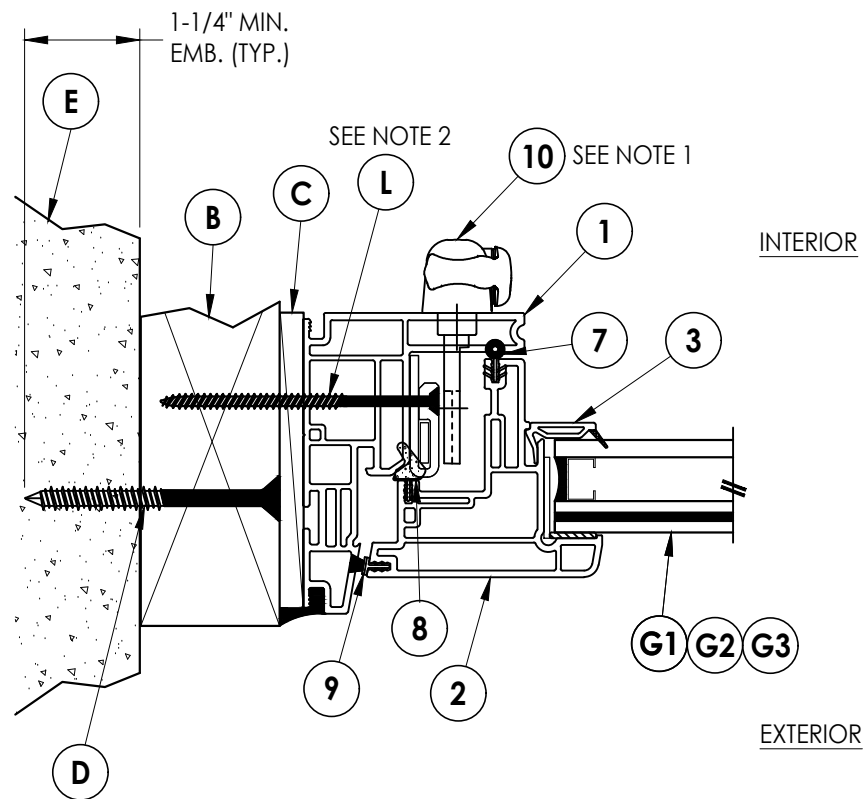

1 HORIZONTAL CROSS SECTION
2 Shown w/ 2X Buck

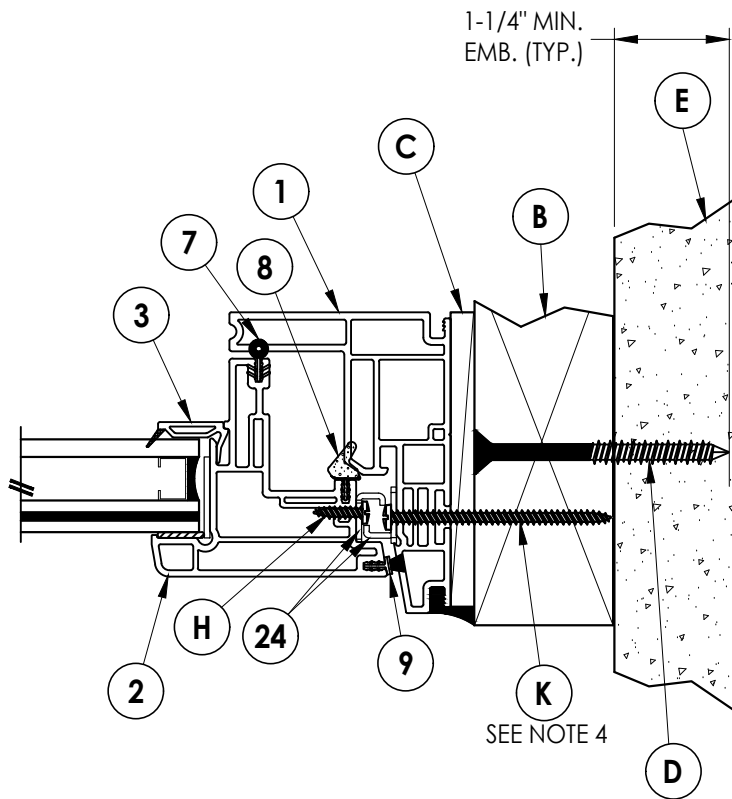

SEE NOTE 4

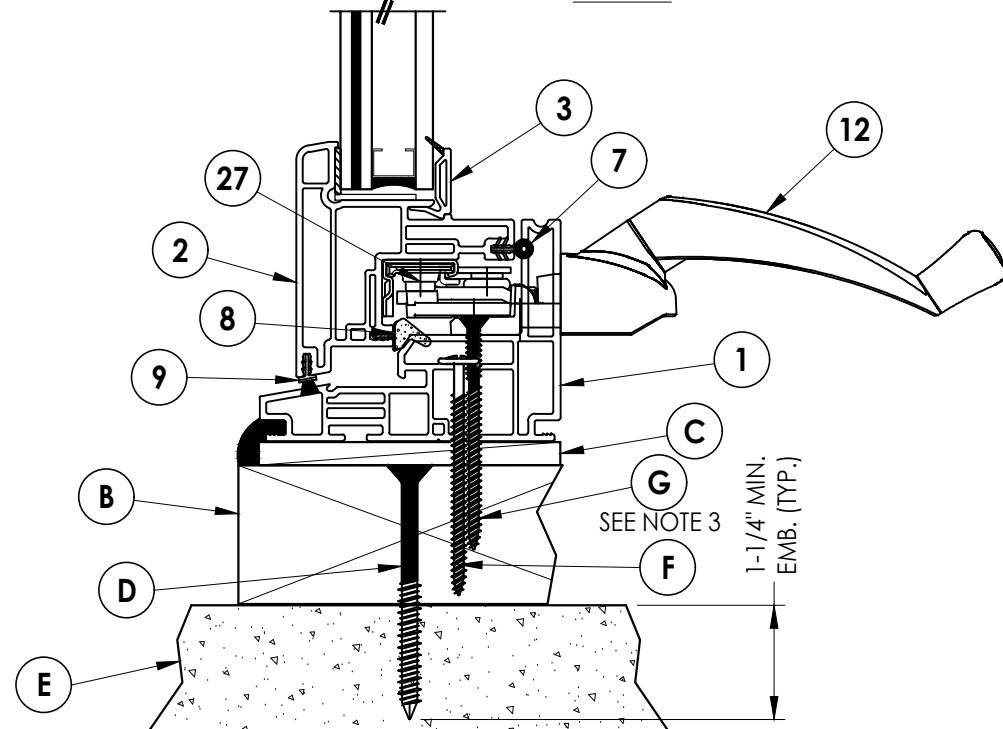

2 VERTICAL CROSS SECTION
2 Shown w/ 2X Buck

Documents Prepared By:
Lyndon F. Schmidt
P.E. No. 43409

PRODUCT:
8800 SERIES
Vinyl Outswing Casement Window

PART OR ASSEMBLY:
HORIZONTAL & VERTICAL
CROSS SECTIONS

RW BUILDING CONSULTANTS, INC.
P.O. Box 230, Vairico, FL 33595
Phone No.: 813.659.9197
FBPE Registry No. 9813

NO.	DATE	REVISIONS
6	7/06/23	UPDATE TO 8TH ED. (2023) FBC
5	7/02/20	UPDATE TO 7TH ED. (2020) FBC
4	4/11/19	REVISE FOR NEW HARDWARE
3	6/01/17	UPDATE TO 6TH ED. (2017) FBC
2	1/28/15	UPDATE TO 5TH ED. (2014) FBC
1	4/04/13	UPDATED D.P./GLAZING

DATE:	8/2/12
SCALE:	N.T.S.
DWG. BY:	JK
CHK. BY:	LFS
DRAWING NO.:	FL-15817.2
SHEET	2 OF 5

Z:\2023 FBC Drawings\Wincore Window Company\FL-15817 R8\FL-15817.2.dwg

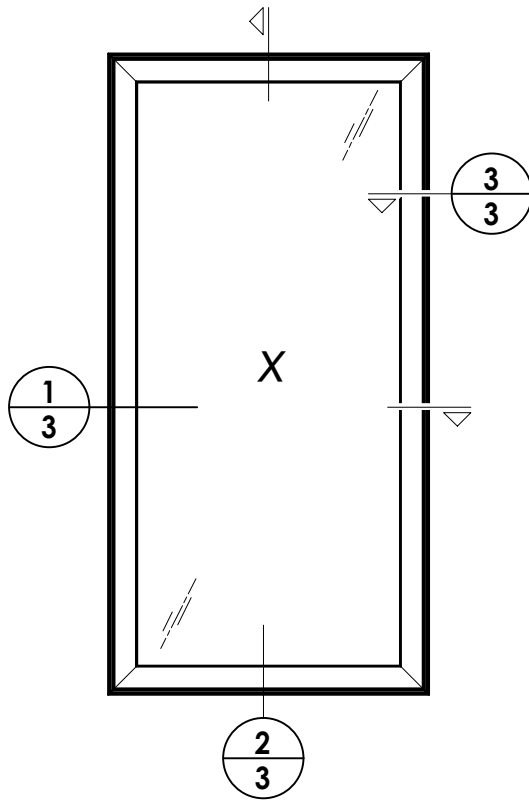

- Notes:
1. Multi-point locks/keepers (4) located at 4.125", 25.75", 46.5" & 66.375" from the bottom of sash.
 2. Item N located in one hole of tie bar guide (1 total per guide).
 3. Item J located in outside holes of operator base (2 total).
 4. Item J located in one hole of snubber (1 total per snubber).

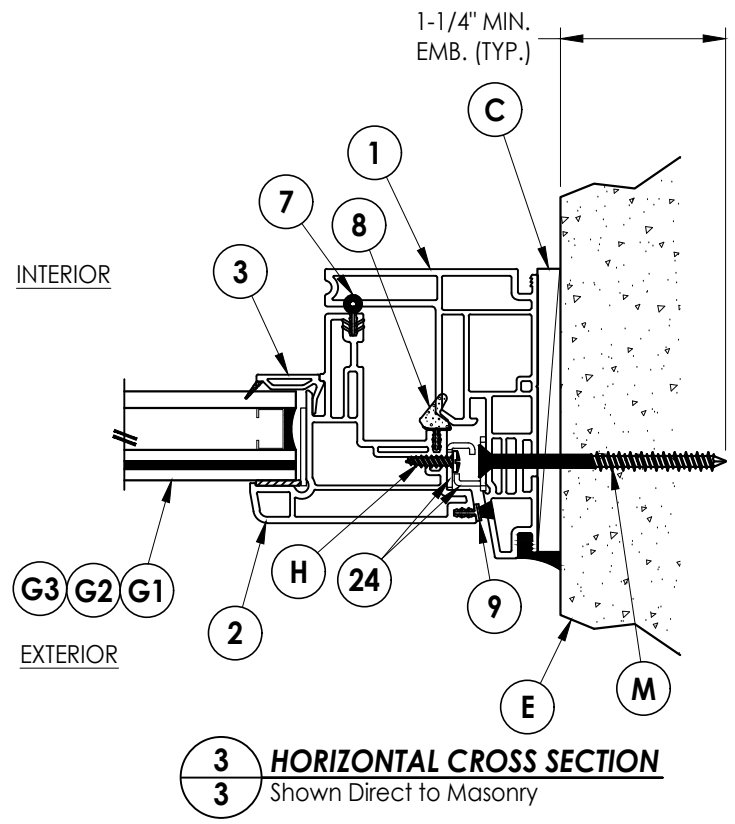

3 HORIZONTAL CROSS SECTION
Shown Direct to Masonry

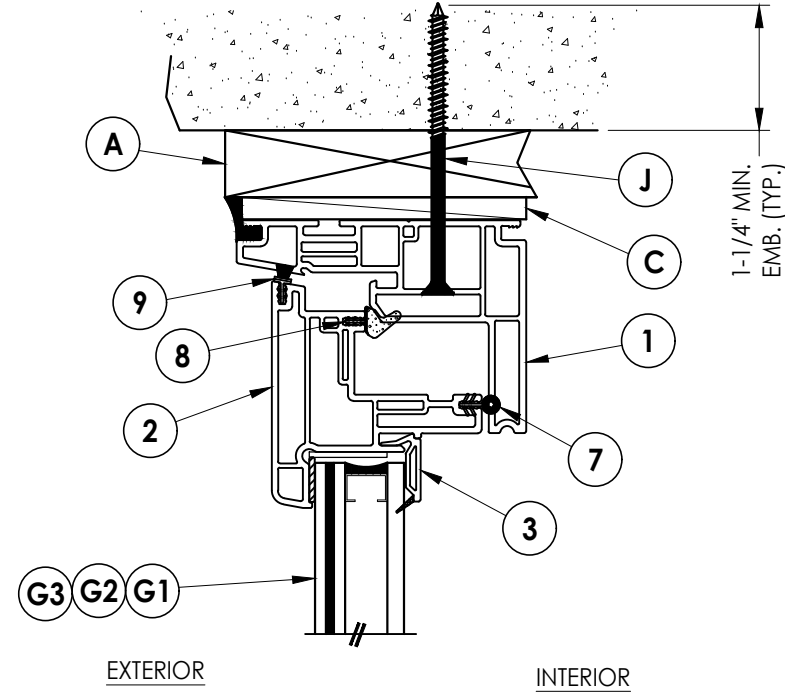

2 VERTICAL CROSS SECTION
Shown w/ 1X Buck @ head & Direct to Masonry @ sill

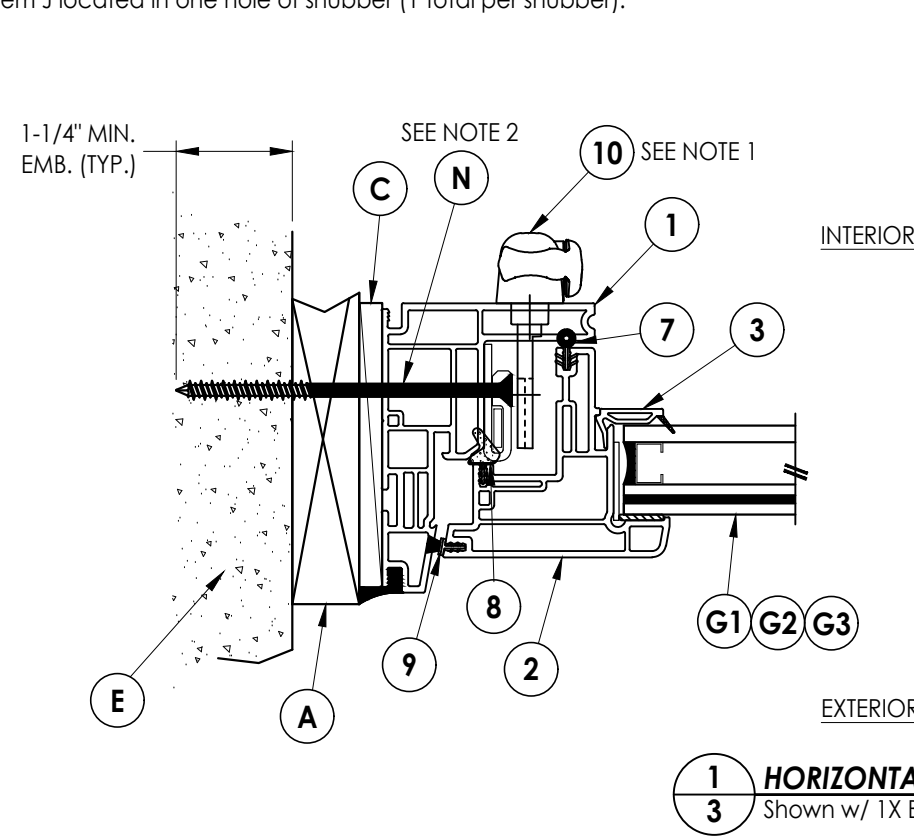

1 HORIZONTAL CROSS SECTION
Shown w/ 1X Buck

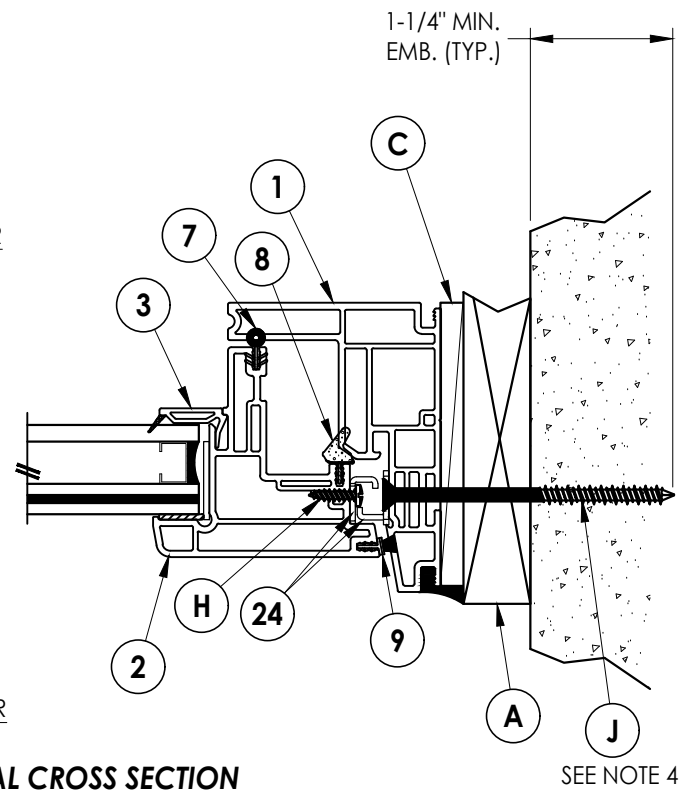

SEE NOTE 4

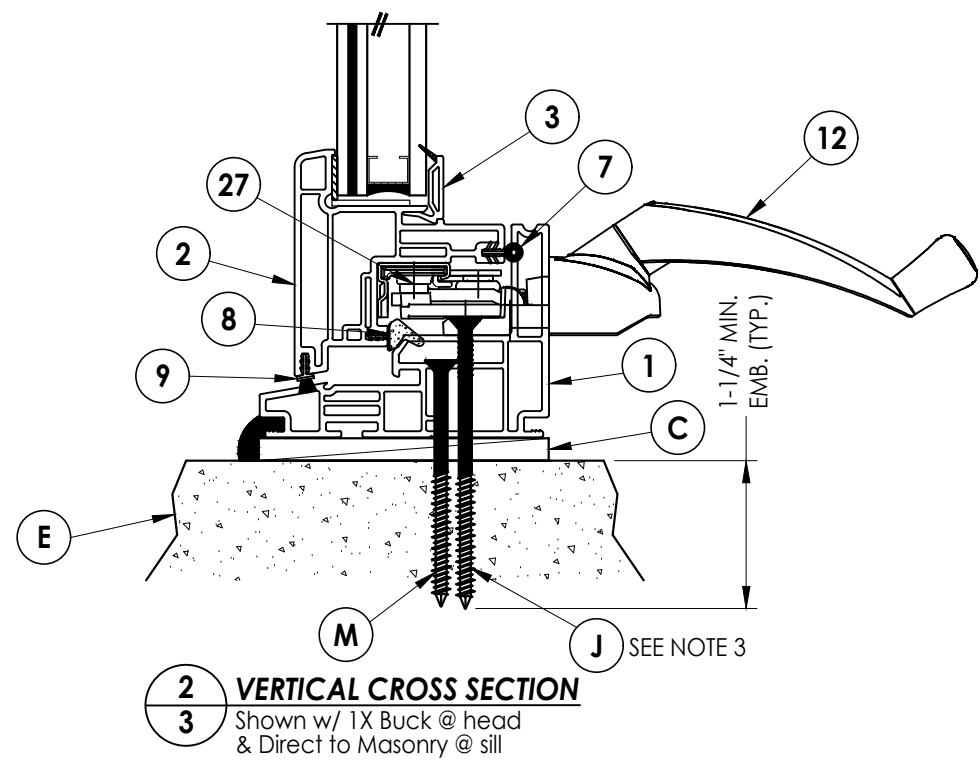

Documents Prepared By: Lyndon F. Schmidt P.E. No. 43409		BUILDING CONSULTANTS, INC. P.O. Box 230, Valrico, FL 33595 Phone No.: 813.659.9197 FBPE Registry No. 9813	
PRODUCT: 8800 SERIES Vinyl Outswing Casement Window		PART OR ASSEMBLY: HORIZONTAL & VERTICAL CROSS SECTIONS	
LFS	UPDATE TO 8TH ED. (2023) FBC	NO.	DATE
LFS	UPDATE TO 7TH ED. (2020) FBC	1	4/04/13
LFS	REVISE FOR NEW HARDWARE	2	1/28/15
LFS	UPDATE TO 6TH ED. (2017) FBC	3	6/01/17
JK	UPDATE TO 5TH ED. (2014) FBC	4	4/04/13
LFS	UPDATED D.P./GLAZING	5	8/2/12
BY			
REVISIONS			
DATE: 8/2/12			
SCALE: N.T.S.			
DWG. BY: JK			
CHK. BY: LFS			
DRAWING NO.: FL-15817.2			
SHEET 3 OF 5			

© 2012 R.W. BUILDING CONSULTANTS INC.

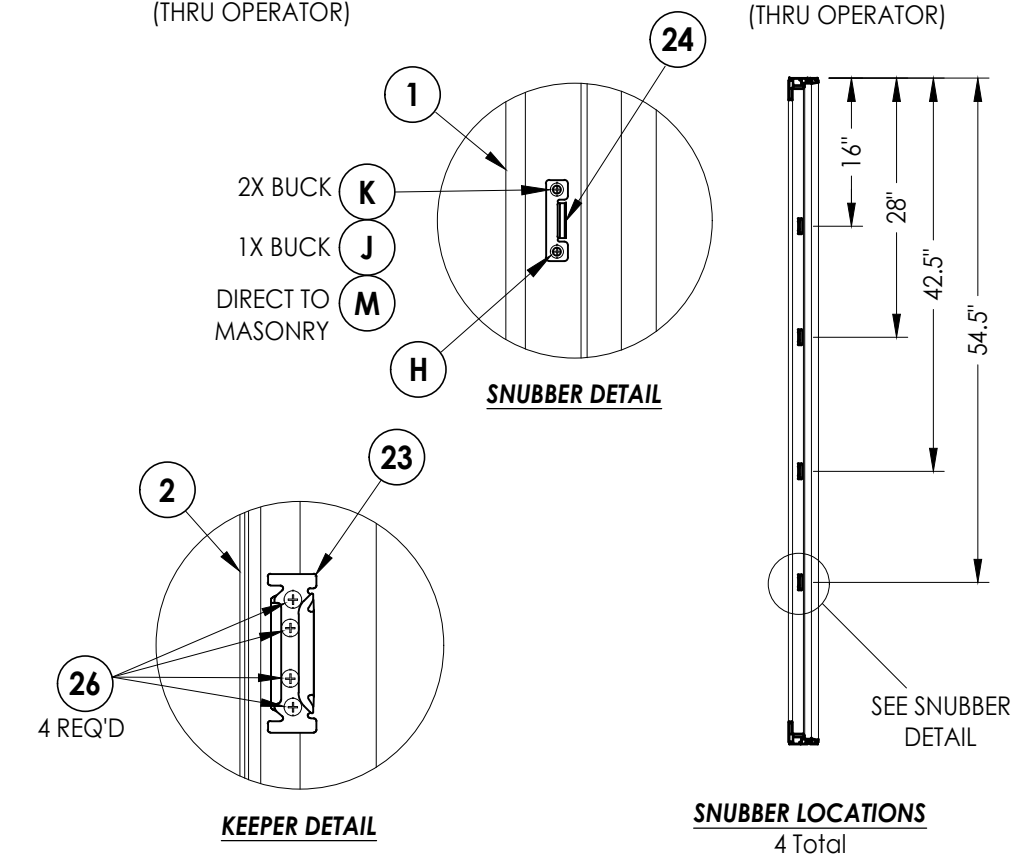
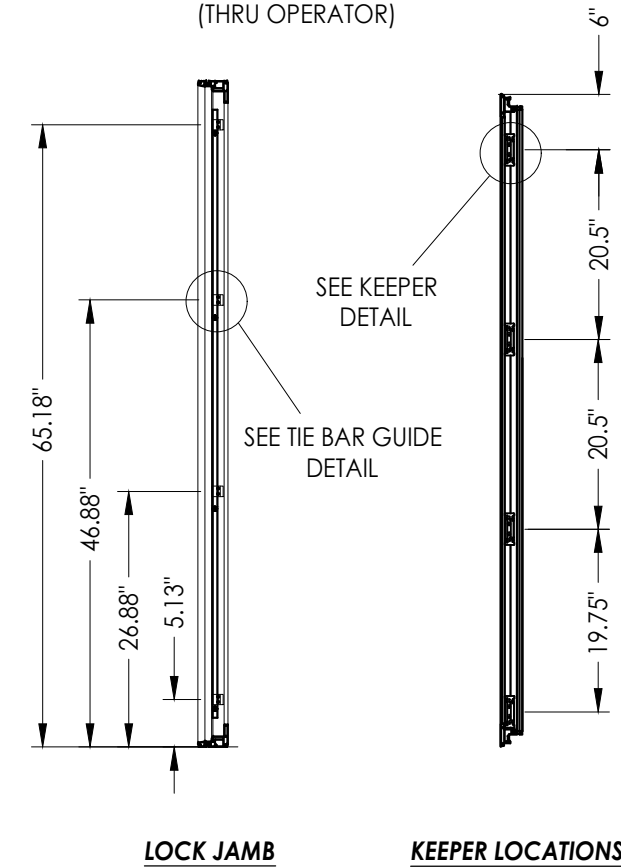
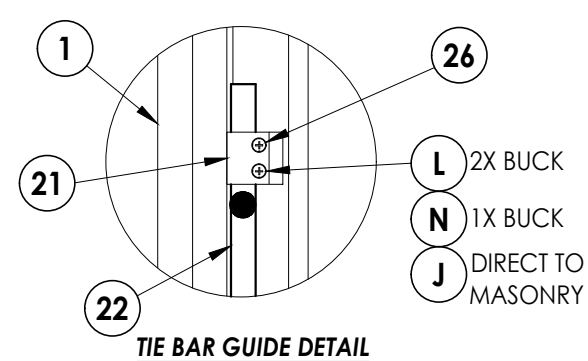
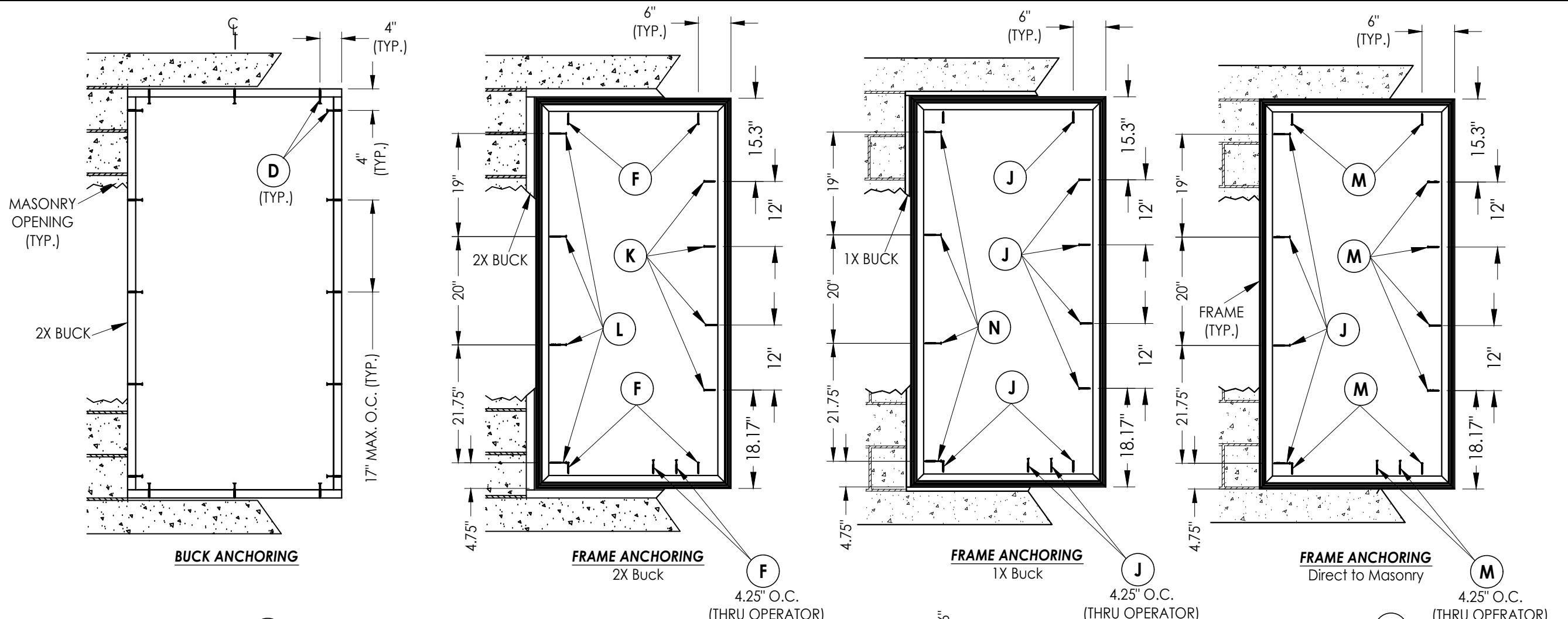

- CONCRETE ANCHOR NOTES:**
- Concrete anchor locations at the corners may be adjusted to maintain the min. edge distance to mortar joints.
 - Concrete anchor locations noted as "MAX. ON CENTER" must be adjusted to maintain the min. edge distance to mortar joints, additional concrete anchors may be required to ensure the "MAX. ON CENTER" dimension are not exceeded.
 - Concrete anchor table:

ANCHOR TYPE	ANCHOR SIZE	MIN. EMBEDMENT	MIN. CLEARANCE TO MASONRY EDGE	MIN. CLEARANCE TO ADJACENT ANCHOR
ITW TAPCON®	3/16" 1/4"	1-1/4"	2"	4"
DeWALT ULTRACON®	3/16" 1/4"	1-1/4"	1"	4"

- WOOD SCREW INSTALLATION NOTES:**
- Maintain a minimum 5/8" edge distance, 1" end distance, & 1" o.c. spacing of wood screws to prevent the splitting of wood.

Documents Prepared By:
Lyndon F. Schmidt
P.E. No. 43409

8800 SERIES
Vinyl Outswing Casement Window

8/2/12

SCALE: N.T.S.

DWG. BY: JK

CHK. BY: LFS

DRAWING NO.: FL-15817.2

SHEET 4 OF 5

REVISIONS

NO. DATE

6 7/06/23 UPDATE TO 8TH ED. (2023) FBC LFS

5 7/02/20 UPDATE TO 7TH ED. (2020) FBC LFS

4 4/11/19 REVISE FOR NEW HARDWARE LFS

3 6/01/17 UPDATE TO 6TH ED. (2017) FBC JK

2 1/28/15 UPDATE TO 5TH ED. (2014) FBC JK

1 4/04/13 UPDATED D.P./GLAZING LFS

BUCK AND FRAME ANCHORING

PART OR ASSEMBLY:

BUCK AND FRAME ANCHORING

PRODUCT:

8800 SERIES
Vinyl Outswing Casement Window

Documents Prepared By:
Lyndon F. Schmidt
P.E. No. 43409

RW BUILDING CONSULTANTS, INC.
P.O. Box 230, Valrico, FL 33595
Phone No.: 813.659.9197
FBPE Registry No. 9813

BILL OF MATERIALS

ITEM #	DESCRIPTION	MATERIAL
A	1X BUCK (SG >= 0.42)	WOOD
B	2X BUCK (SG >= 0.42)	WOOD
C	1/4" MAX. SHIM SPACE	-
D	1/4" X 2-3/4" PFH DeWALT OR ITW CONCRETE SCREW	STEEL
E	MASONRY - 3,000 PSI MIN. CONCRETE CONFORMING TO ACI 301 OR HOLLOW BLOCK CONFORMING TO ASTM C90	CONCRETE
F	#8 X 2-1/2" MODIFIED TRUSS HEAD (7/16" Ø) SMS (1-3/8" MIN. EMBEDMENT)	STEEL
G	#8 X 2-1/2" PFH WOOD SCREW (7/8" MIN. EMB.)	STEEL
H	#8 X 1/2" PPH SMS	STEEL
J	3/16" X 3-1/4" PFH DeWALT OR ITW CONCRETE SCREW	STEEL
K	#8 X 2-1/2" PPH WOOD SCREW (1-1/2" MIN. EMB.)	STEEL
L	#8 X 3" PFH SMS (1-5/16" MIN. EMB.)	STEEL
M	3/16" X 2-3/4" PFH DeWALT OR ITW CONCRETE SCREW	STEEL
N	3/16" X 3-3/4" PFH DeWALT OR ITW CONCRETE SCREW	STEEL
1	FRAME*	PVC
2	SASH*	PVC
3	GLAZING BEAD*	PVC
7	WEATHERSTRIP AMESBURY (CS 120 33-SEAL)	FOAM
8	WEATHERSTRIP AMESBURY (12300 SEAL)	VINYL
9	WEATHERSTRIP ULTRA FAB .250 (PILE - 250 - KP52)	VINYL
10	MULTI-POINT LOCK (TRUTH) 24.33.32.004	-
12	OPERATOR HANDLE (TRUTH) 50.10.00.011	-
21	TIE BAR GUIDE (TRUTH) 32384	-
22	TIE BAR (TRUTH) 12926	-
23	KEEPER (TRUTH)	-
24	SNUBBER (TRUTH) (SASH/FRAME) 22999	-
26	#8 X 1/2" PFH SMS	S.S.
27	OPERATOR (TRUTH STANDARD, MAX. CLEAR OR STAINLESS STEEL)	STEEL

* THE APPROVED WHITE RIGID PVC EXTERIOR EXTRUSIONS FOR WINDOWS ARE TO BE PRODUCED BY EXTRUDERS LICENSEES IN "AAMA CERTIFICATION PROGRAMS FOR RIGID PVC EXTRUSIONS".

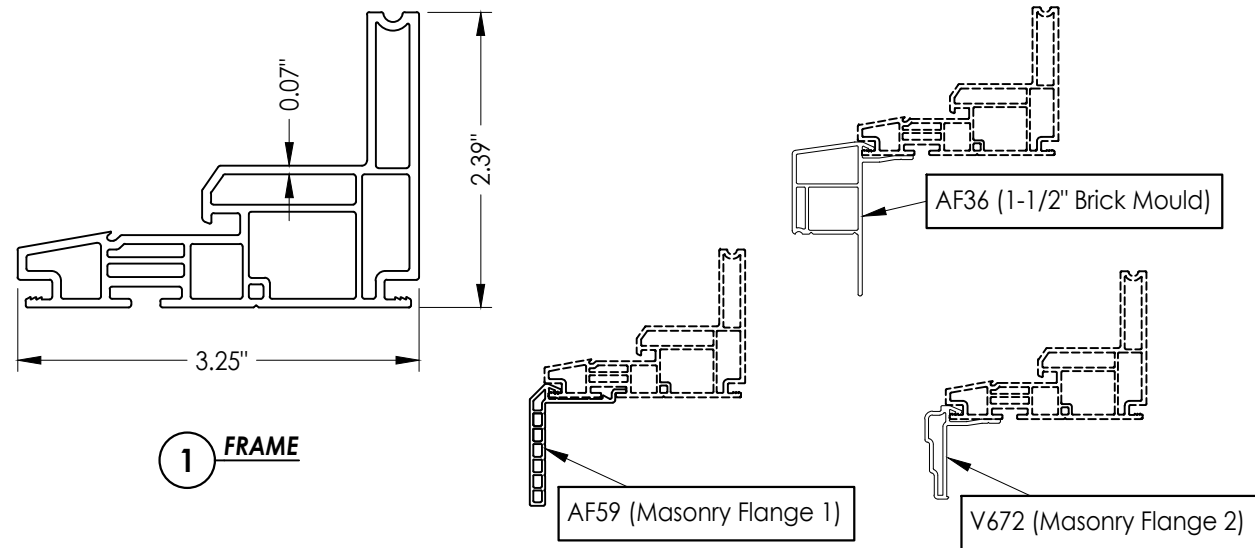

OPTIONAL COSMETIC FLANGES

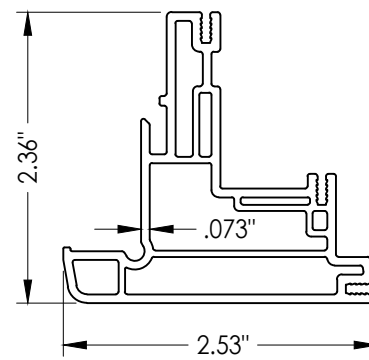

2 SASH

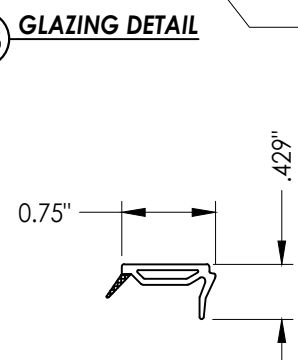

3 GLAZING BEAD

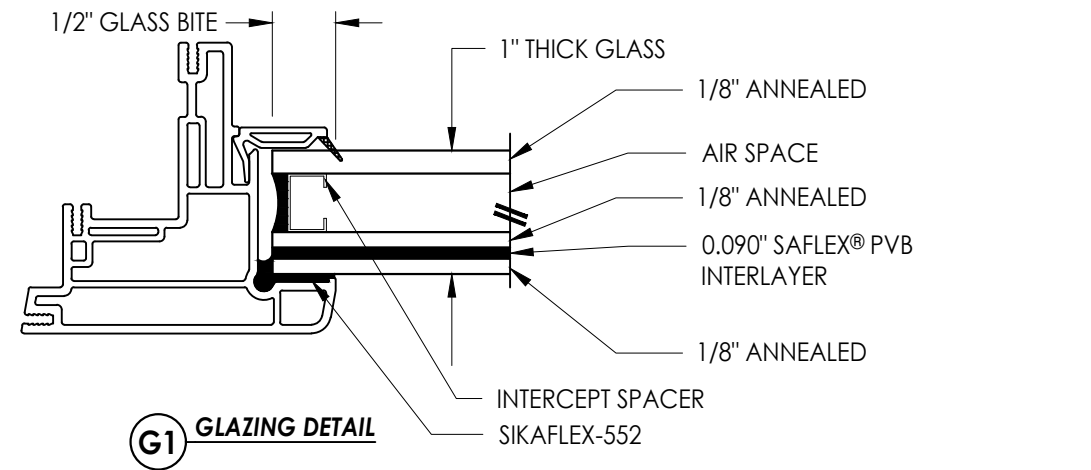

G1 GLAZING DETAIL

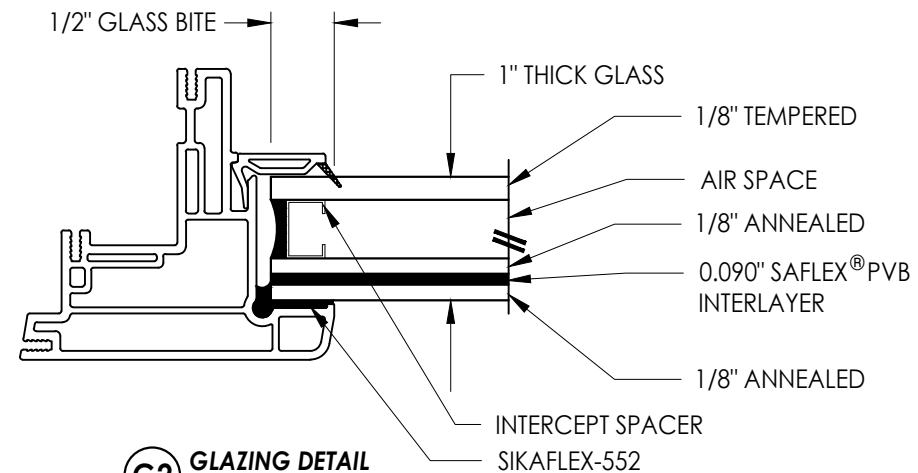

G2 GLAZING DETAIL

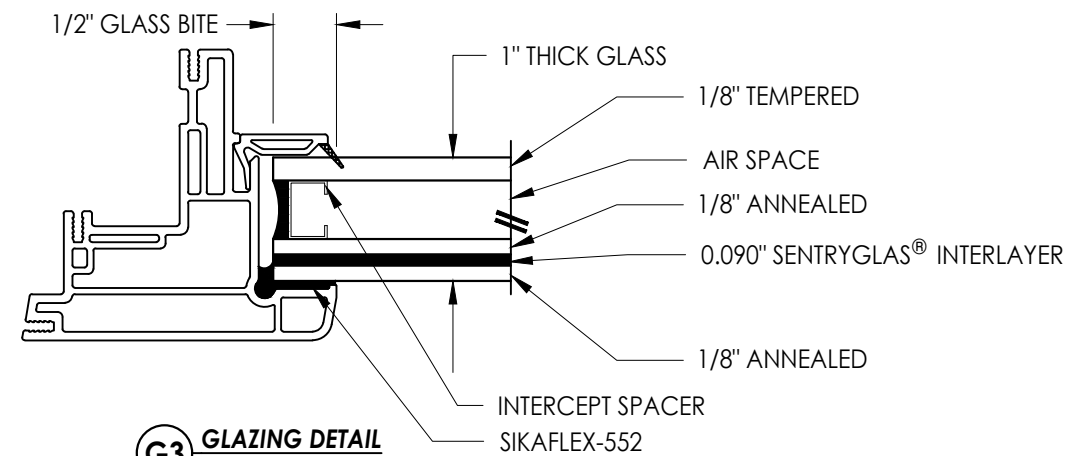

G3 GLAZING DETAIL

Documents Prepared By:
Lyndon F. Schmidt
P.E. No. 43409

PRODUCT: 8800 SERIES
Vinyl Outswing Casement Window

NO.	DATE	DESCRIPTION	BY
6	7/06/23	UPDATE TO 8TH ED. (2023)	FBC
5	7/02/20	UPDATE TO 7TH ED. (2020)	FBC
4	4/11/19	REVISE FOR NEW HARDWARE	LFS
3	6/01/17	UPDATE TO 6TH ED. (2017)	FBC
2	1/28/15	UPDATE TO 5TH ED. (2014)	FBC
1	4/04/13	UPDATED D.P./GLAZING	LFS

DATE: 8/2/12

SCALE: N.T.S.

DWG. BY: JK

CHK. BY: LFS

DRAWING NO.:

FL-15817.2

SHEET 5 OF 5

RW BUILDING CONSULTANTS, INC.
P.O. Box 230, Valrico, FL 33595
Phone No.: 813.659.9197
FBPE Registry No. 9813

PART OR ASSEMBLY:
BILL OF MATERIALS, COMPONENTS
AND GLAZING DETAIL